

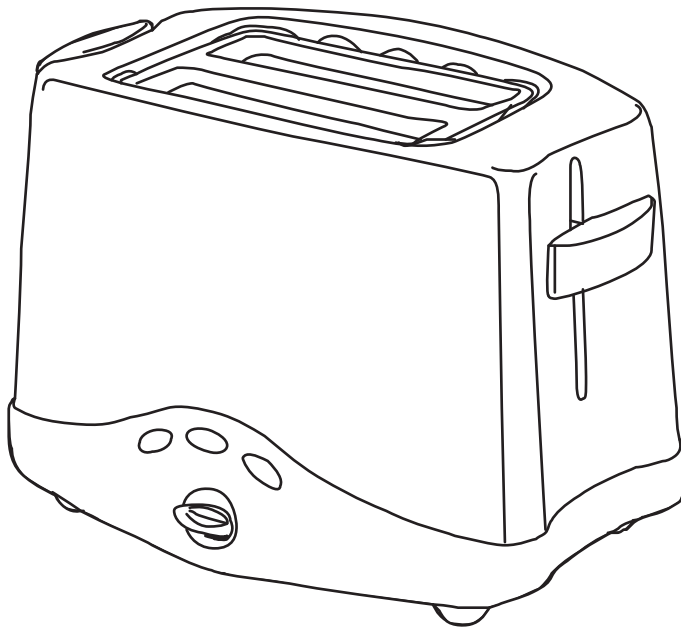

# mellerware®

E X E C U T I V E

Alpha Steel Toaster



complies with  
INTERNATIONAL  
IEC60335  
SAFETY SPECIFICATIONS



Model:  
24109

**PLEASE READ ALL INSTRUCTIONS BEFORE USE**

**2 year guarantee**



## IMPORTANT SAFEGUARDS

When using electrical this appliances, basic safety precautions should always be followed, including the following:

1. Read all the instructions before use and retain for future reference.
2. Do not touch hot surfaces. Use handles or knobs.
3. To protect against fire and risk of electrical shock do not immerse cord, plug or toaster itself in water or other liquid.
4. Ensure that this appliance is situated out of reach of children.  
NEVER allow a child to use this product.
5. Unplug from the socket when not in use and before cleaning. Allow to cool before putting on or taking off parts.
6. Do not operate any appliance with a damaged plug, or after an appliance has malfunctioned, or has been dropped or damaged in any way. **This appliance contains no user serviceable parts.**
7. Do not use outdoors.
8. Do not let the mains lead overhang the edge of the table or worktop, or touch hot surfaces.
9. **Do not place the appliance on or near a hot surface such as a gas or electric stove, or in a microwave oven.**
10. Do not attempt to move the appliance whilst hot.
11. When unplugging turn any control to off, then remove plug from wall socket.
12. Do not use appliance for other than intended use.
13. Pre-heating of this appliance is not required.
14. **Do not touch the metal top of the toaster during or after use, as this surface gets very hot. Use plastic handles and knobs.**
15. Ensure that sufficient space is left above and around all sides of your toaster to allow air to circulate. Place the toaster on a heat resistant surface. Do watch your toaster during use. A fire may occur if toasters are covered or touching flammable material including curtains, draperies, walls etc, when in operation.
16. **Do not use underneath or inside cupboards.**
17. Oversize foods, metal foil packages, or utensils must not be inserted into a toaster, as they may involve a risk of fire or electric shock.
18. Do not attempt to dislodge food when toaster is plugged in and never introduce cooking utensils into the slots.
19. **Do not place bread or other items on top of the bread slot as this will damage your toaster and creates a fire hazard. Use the integrated bun warmer.**

**If your toaster does not work, check the following points:**

1. Has the toaster been set correctly - is the plug in its socket and the switch in the 'on' position?
2. Is the plug itself or the socket faulty? Check this by plugging in another appliance of similar power rating.
3. Does the fuse need replacing-if you have fitted your

own plug, are the internal plug connections secure and correctly made (UK only)?

4. Do not lift or move the toaster by inserting fingers in bread slot.
5. If the supply cord is damaged, it must be replaced by the manufacturer, its appointed service agent, or a similar qualified person in order to avoid a hazard.

## SAVE THESE INSTRUCTIONS

### Electrical Requirements

Check that the voltage on the rating plate of your appliance corresponds with your house electricity supply which must be A.C. (Alternating Current).

**IMPORTANT:** If the plug or supply cord on your appliance is faulty send to an authorized service center or agent for replacement or repair. Any repair or attempted repair by an unauthorized service agent will invalidate the warranty.

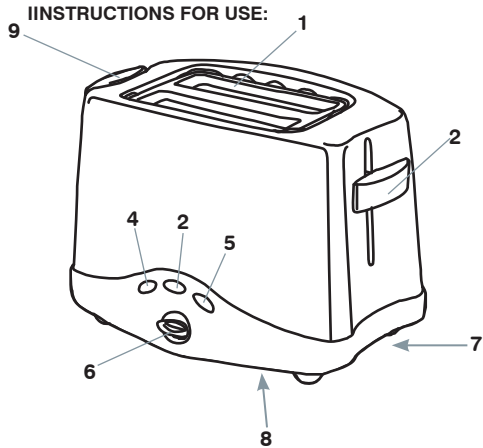

### Key:

1. Wide slots with bread centering
2. Bread Carriage Lever with high lift function.
3. Cancel Button
4. Frozen Button
5. Bagel/Crumpet Button
6. Variable browning control knob
7. Removable Crumb Tray
8. Cord Storage
9. Integrated Bun Rack Handle



Please read before use, taking careful note of points 1 and 2.

1. Use your toaster once without bread. This will pre-heat the new elements and burn off any dust that may have accumulated during storage.
2. Select the desired level of browning on the browning control (6) marked 1 to 6. The setting required will vary according to the moisture content and thickness of bread. For best results ensure that the bread slices are of even thickness, freshness and size. Remember that stale bread toasts more rapidly than fresh and thin bread toasts quicker than thick. See additional points for more information.
3. After selecting the desired browning level, place your bread in the bread slots and depress the bread carriage lever (2) downwards until it locks.

**Note: The bread carriage lever will not stay down unless the toaster is plugged in and the mains switch is on.**

4. After the set degree for browning has been reached, the bread will pop-up automatically, ready for removal from the slots. The bread carriage lever will have returned to its upper position and the heating element will have switched off, ready for the next toasting.
  - If the first slices are not dark enough turn the browning control to a higher setting.
  - If the bread in your toaster becomes jammed disconnect your toaster at the mains power supply, allow it to cool, then remove the bread by turning the toaster upside down. Do not insert any objects into the toaster.
  - When not in use, switch your toaster off at the mains and remove the plug from the socket. **DO NOT WRAP THE CABLE AROUND THE MAIN BODY OF THE APPLIANCE DURING OR AFTER USE.**

#### Using the cancel setting

If you wish to interrupt the toasting process, press the cancel button (3).

#### Using the high lift release

If small bread is toasted, this may be removed more easily by lifting the bread carriage lever (2).

#### Using the defrost button

To toast frozen bread, do not adjust the browning control, place the bread normally in the bread slot, depress the bread carriage lever and press the frozen bread button (4). The button will illuminate and the toaster will automatically toast for an extended period.

#### Using the Crumpet function

To toast one side of a crumpet or bagel, place the bread normally in the bread slot, depress the bread carriage lever and press the crumpet button (5). The button will illuminate indicating this function is in operation.

#### Crumb tray

Crumbs will accumulate in the crumb tray (7) and could cause a hazard if not emptied periodically. When the toaster has cooled down completely, tap the sides of the case lightly to dislodge any crumbs

lodged in the toasting chamber and pull out the crumb tray. Empty the tray and replace it.

**NB! Never operate the toaster without the crumb tray fitted.**

#### Additional points

In order to achieve uniform browning, we recommend you wait a minimum of 30 seconds between each toasting, so that the control can automatically be reset.

If toasting one slice only, you may need to adjust the browning control to a slightly lower setting.

- **Note** you will also notice a slight variation in toast colour on one side of a single slice.
- Stale bread toasts more rapidly than fresh bread. The browning control should be set at a lower setting than usual.
- All types of bread can be used, as well as teacakes, and small rolls etc. Slices should not however be so thick as to cause burning or jamming within the bread slot.
- Allow the toaster to cool fully before storing away.

#### CLEANING AND MAINTENANCE

1. After use and before cleaning, switch off at the mains, remove the plug from the mains power supply and wait for the toaster to cool.
2. Wipe the outside of the toaster with a damp cloth only and dry with another cloth or tissue.
3. NEVER use coarse scouring agents, and never immerse your toaster in any liquid.
4. NEVER use any pointed or sharp articles for cleaning the inside of the toaster otherwise the heating element will be damaged.
5. **NEVER use a brush or push your fingers or metal objects down the slots.**





## creative housewares

27 Nourse Avenue Epping 2 Cape Town  
P.O. Box 975 Eppindust 7475 South Africa  
Tel: +27 21 534 8114 Fax: +27 21 534 8086  
Service Centre Share Call: 086 111 5006  
web: [www.creativehousewares.co.za](http://www.creativehousewares.co.za)

